

SAFETY INFORMATION

Please read and understand this entire manual before attempting to assemble, install or operate the product.

WARNING

- RISK OF ELECTRIC SHOCK - Before beginning installation, turn off electricity at the circuit breaker box or the main fuse box.

CAUTION

- For your safety, read instructions completely before beginning installation.
- If in doubt about electrical installation, consult a licensed electrician.

TOOLS REQUIRED

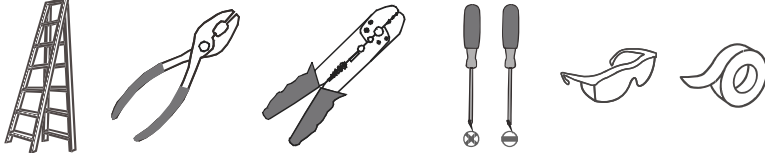

Ratings	120Vac, 60Hz	
	Model No.	Wattage
	PCGAB449MBK	40W

CARE AND MAINTENANCE

- Wipe clean using soft, dry cloth or static duster. Always avoid using harsh chemicals and abrasives to clean fixture as they may damage the finish.

If you need further assistance call Quozel Customer Care at 1-800-645-3184 (9:00am - 5:00pm EST), or visit us on-line at www.quezel.com.

PACKAGE CONTENTS

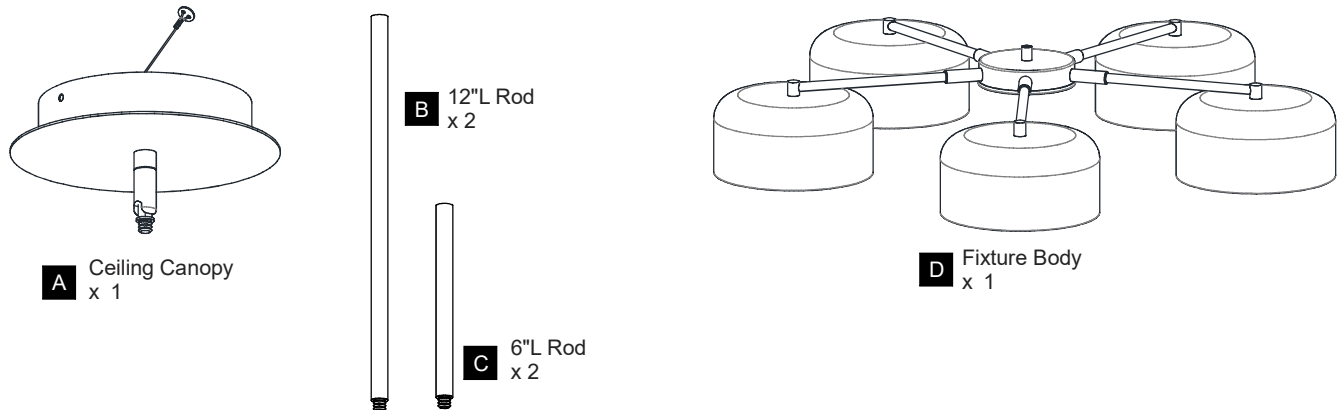

MOUNTING HARDWARE



INSTALLATION

1 Install Rods

Optional Rods:

8 Feet Ceiling:
(2) 12"L Rods.
9 Feet Ceiling:
(2) 6"L Rods + (2) 12"L Rods.

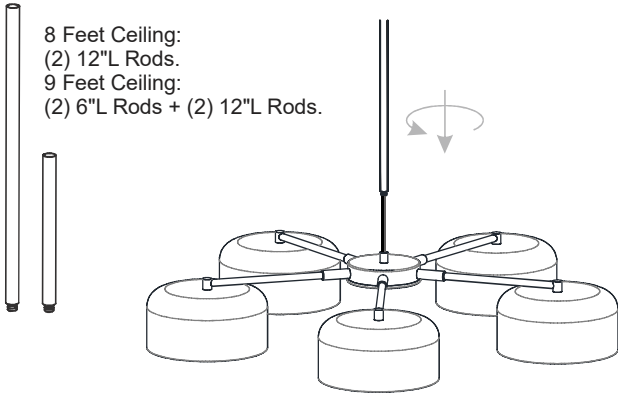

5 Install Lanyard

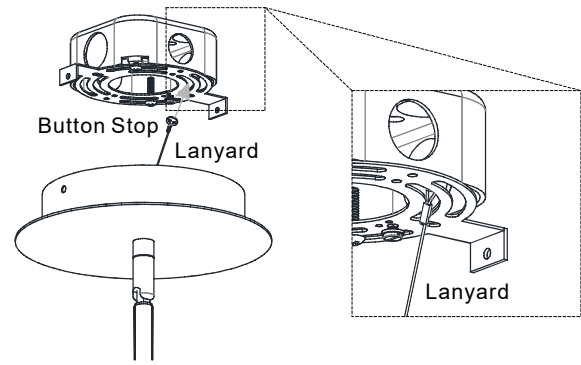

2 Install Ceiling Canopy to Upper Rod

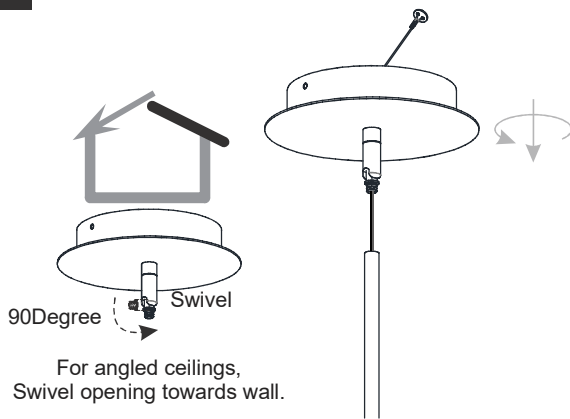

6 Wiring to Driver Input

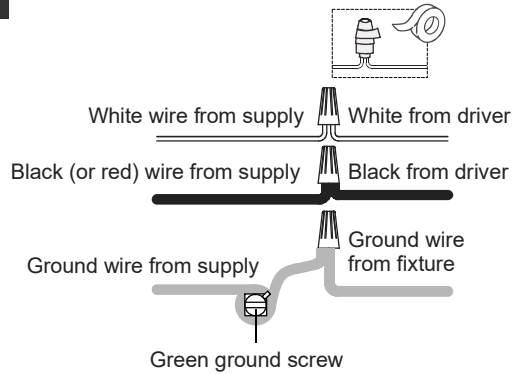

3 Wiring to Driver Output

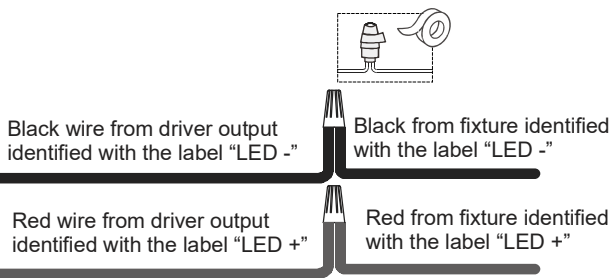

7 Install Ceiling Canopy to Inner Backplate

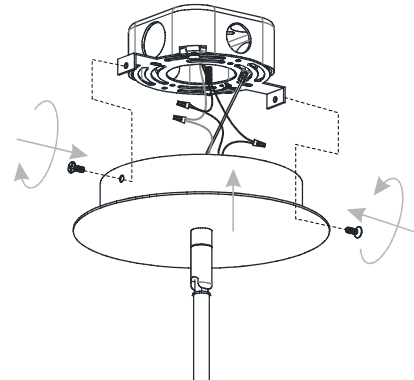

4 Install Inner Backplate

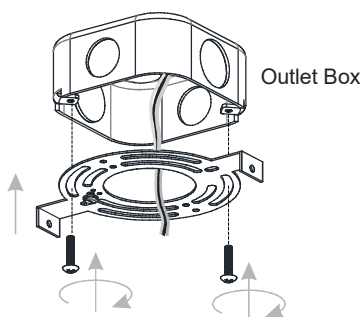

8 Adjust Diffuser (if necessary)

* Adjust the diffuser to make sure it is seated in the shade properly.

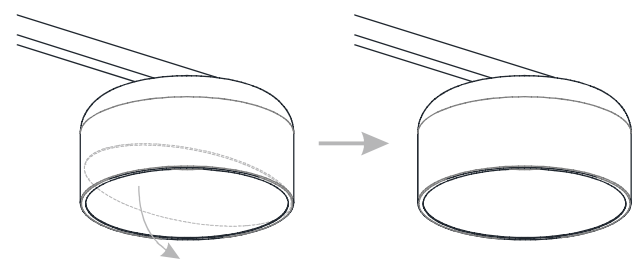

Your installation is now complete! Restore electricity and save this sheet for future reference.