

DAWN – model: WS-W22

LED Outdoor Sconce Luminaire

MODERN FORMS



Fixture Type:

Catalog Number:

Project: _____

Location: _____

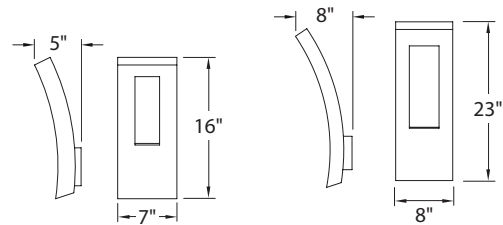

PRODUCT DESCRIPTION

Cutting edge abstract design to complement modern architecture. Energy efficient indirect ambient lighting and down lighting creates bright, beautiful spatial illumination for superb security and architectural accent. Dawn provides a distinctive profile that reflects the best in urban refinement and sophistication.

FEATURES

- ETL & cETL listed for wet locations, IP65
- Back light and down light
- Replaceable LED module
- 277V option available *special order*
- 50,000 hour potential life
- **Color Temp: 3000K**
- **CRI: 85**

SPECIFICATIONS

- Construction:** Aluminum
- Power:** No driver or transformer required
- Light Source:** High output LED
- Dimming:** Dims to 10% with an electronic low voltage (ELV) dimmer
- Mounting:** Mounts directly to junction box
- Finish:** Bronze (BZ), Graphite (GH), Black (BK)
- Standards:** ETL & cETL, Wet Location listed, IP65

ORDER NUMBER

Model#	Height	Finish
WS-W22	16"	BZ <i>Bronze</i>
	23"	GH <i>Graphite</i>
		BK <i>Black</i>

FIXTURE PERFORMANCE

Part#	Watt	# of LEDs	LED Lumens	Photometric Lumens
WS-W2216	16W	4	960	490
WS-W2223	24W	6	1440	735

REPLACEMENT GLASS

Part#	Fixture
RPL-GLA-2216	WS-W2216
RPL-GLA-2223	WS-W2223

WS-W22 -

Example: **WS-W2223-GH**
 For 277V special order, add an "F" before the finish: **WS-W2223F-GH**

modernforms.com
 Phone (800) 526.2588
 Fax (800) 526.2585

Headquarters/Eastern Distribution Center
 44 Harbor Park Drive
 Port Washington, NY 11050

Central Distribution Center
 1600 Distribution Ct
 Lithia Springs, GA 30122

Western Distribution Center
 1750 Archibald Avenue
 Ontario, CA 91760